

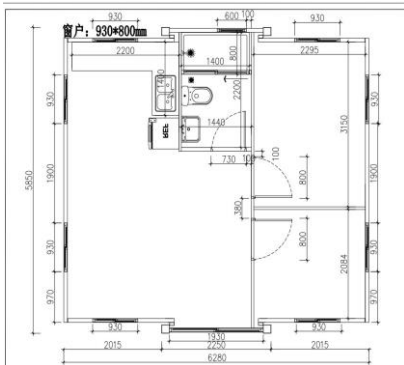







BDI WEAR PARTS
Premium Crusher Wear Parts

BDI Wear Parts

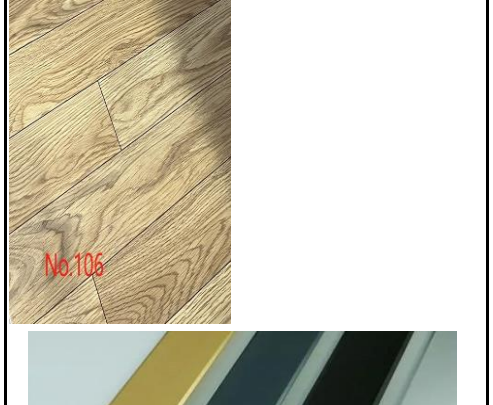
Quotation Of 20 Feet Expandable Container House Plus Edition



No	Name	Specification	House show	Picture
Size		5850mm*2250mm*2530mm (L*W*H) ,this size is packing size for shipping 5850mm*6280mm*2530mm(L*W*H),this size is expandable size. 6850mm*6280mm*2530mm(L*W*H),this size is after installing size		
1	Floor	1.First Layer : 15mm MGO/BULU Board ; 2. Second layer : 1.6mm PVC floor. Color Choose:106/270-8 Expand middle position gaps aluminum cover part		
2	Roof	1.75mm EPS With Double Side 0.5mm Steel Sandwich panel		
3	wall	2. Central External Roof 3mm Steel Panel 3. Central Internal Roof extra glass wool insulation and bamboo fiberboard cover panel		

4	Door	<p>1.Exterior door (tempered glass) : Broken Bridge Aluminum Frame Sliding glass door with 3 keys and Fly screen 1900mm*2035mm Frame color can choose black or white</p> <p>2.Interior door : Single opened door with 3 keys*2 (700mm*2035mm)</p>
---	------	--



5	Window A (tempered glass)	<p>Broken Bridge Aluminum Frame Sliding Double Layer Windows With Fly Screens. Frame color can choose black or white and prefab in factory. Size:930mm*1100mm. Quantity:8 units</p>
---	---------------------------	--



	Window B (tempered glass)	<p>Double Layers Glass Window In Bathroom. Size:600mm*600mm. Quantity: 1 Unit</p>
--	---------------------------	---



6	Electric system (CE/UL/SA A/BS I/BV/CSA standard)	<p>1. One Of Distribution Junction Box ; 2. Ceiling Lights/Switches and sockets.</p>
---	---	--



7	Bathroom	<p>1.*Hand Washbin With Board and Mirror</p> <p>2.*Glass Sliding Showerroom With ABS foundation or tiles shower room need choose</p> <p>3.*Toilet</p>
---	----------	--

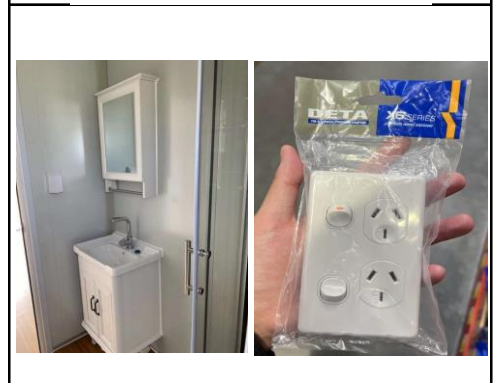

8	Plumbing system	AU/US/EU Standard PPR Water Pipes and PVC pipes		
9	Kitchen cupboard	2200x1400 Kitchen cupboard , Quantity:1 unit		

Plus-Edition additional upgrade option If you have any questions, please communicate with sales

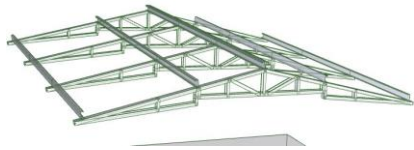
10	Extra Roof System (Pick 1 of 2)	<p>(700.00CAD) Double Side Extra Fibre-reinforced plastic 3mm cover better waterproof and insulation</p>	<p align="center">Before change</p> 	<p align="center">After change</p> 
		<p>(2100.00CAD) Hot Galvanized Light Steel Structure System With 50mm Ripple EPS Sandwich Panel</p>		
11	Cladding Decoration Panel	<p>(2100.00CAD) 15mm Polyurethane Panel</p>		
12	Bathroom wall decoration panel	<p>(700.00CAD) bamboo fiberboard waterproof panel</p>		

13	Balcony& Varandahh	<p>(2100.00CAD) 1m Length Balcony Steel Structure With WPC Outside Floor and fence with extra 1m pitch roof</p>		
14	Floor remove	<p>(900.00CAD) Change to 4mm SPC floor Color can choose ask sales brochure</p>		
15	Shipping Details And Photos	 		
16	Manufactu re Time	<p style="text-align: center;">25 Days</p>		
17	1 Unit Of FOB Toronto	<p style="text-align: center;">21300.00CAD+Extra Materials Price</p>		